

Conelock Nut

Known as: Prevailing Torque Lock Nut & Stover Grade C

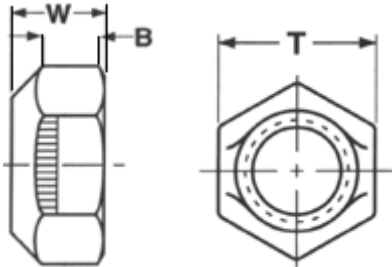

Type A = NCLA020----Z1

Type B = NCLB050----Z1

Type C = NCLC080----Z1

Nominal Size	T Across Flats	W		B Hex Height	Weight per C
		Total Height			
		Max	Min		
1/4	7/16	.226	.212	.145	.7
5/16	1/2	.273	.258	.166	1.10
3/8	9/16	.337	.320	.198	1.60
7/16	11/16	.385	.365	.223	2.80
1/2	3/4	.448	.427	.262	3.80
9/16	7/8	.496	.473	.286	5.80
5/8	15/16	.559	.535	.329	7.30
3/4	1-1/8	.665	.617	.382	11.9
7/8	1-5/16	.776	.724	.450	19.00
1	1-1/2	.887	.831	.513	28.30